

KPA500 KIT ASSEMBLY MANUAL ERRATA

Rev. F6-3, December 23, 2016

E740149E

**MAKE THESE CHANGES TO YOUR REV F6
MANUAL OR ANNOTATE THE TEXT TO REFER TO THIS
ERRATA AT THE PLACES INDICATED**

1. Page 25, replace the last check box step and Figure 34 with the following:

Connect the 270V wire from the power supply module to the PA/LPF module as shown in Figure 34. **Support the pc board so it does not flex while mating the connector.** This is the connector you routed through the hole in the Z-bracket earlier.

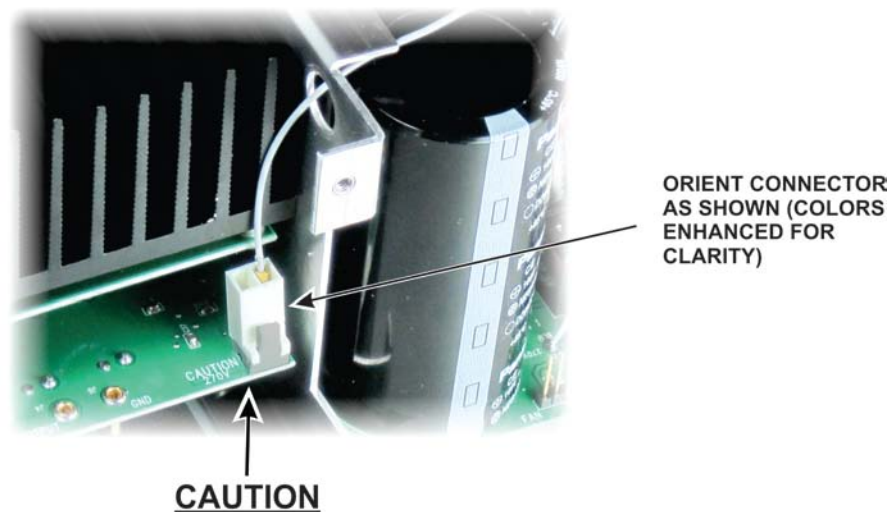

CAUTION
SUPPORT THE BOARD FROM BELOW WITH YOUR FINGERS
WHILE ATTACHING THE CONNECTOR SO THE BOARD CANNOT FLEX.
ALLOWING THE BOARD TO FLEX MAY BREAK COMPONENTS ON THE BOARD.

Figure 34. Connecting the 270V Wire to the PA/LPF Module.

- 2. Page 42, Figure 62:** Change the length of the screw shown from 3/8" (9.5 mm) to 7/16" (11 mm).
- 3. Page A-3 (Parts List), KPA500 Carry Handle Bag – E850453:** Change the length of the 8-32 screw to 7/16" (11 mm) and change the part number for the screw to E700356.
- 4. Page A-4 (Parts List):** Change the serial number label part number from E850187 to E850450.